

CERTIFIED LAND CORNER RECORDATION

DESCRIPTION OF CORNER EVIDENCE FOUND, AND ORIGINAL RECORD (if known)

LOCATION: $\frac{1}{4}$ S.13
 $\frac{1}{4}$ S.24
 T.12N., R.62W.
 6th P.M.

DESCRIPTION: No evidence found. Corner re-established by single proportionate measurement.
 G.L.O. record - Iron post, 3 ft. long, 1 in. dia., $2\frac{1}{2}$ ft. in ground with brass cap. 1911

DESCRIPTION OF MONUMENT AND ACCESSORIES ESTABLISHED TO PERPETUATE THE ORIGINAL LOCATION OF THIS CORNER:

At the corner: Set a $1\frac{1}{2}$ " dia. x 30" long iron pipe with brass cap.
 Accessories: A 4" x 4" Redwood post, 4' long, 18" in the ground bears SW'ly, 1 foot distant.

SKETCH, WITH COURSE AND DISTANCE TO ADJACENT CORNER IF DETERMINED IN THIS SURVEY.
 (May Sketch or Paste Reproduction on Reverse Side.)

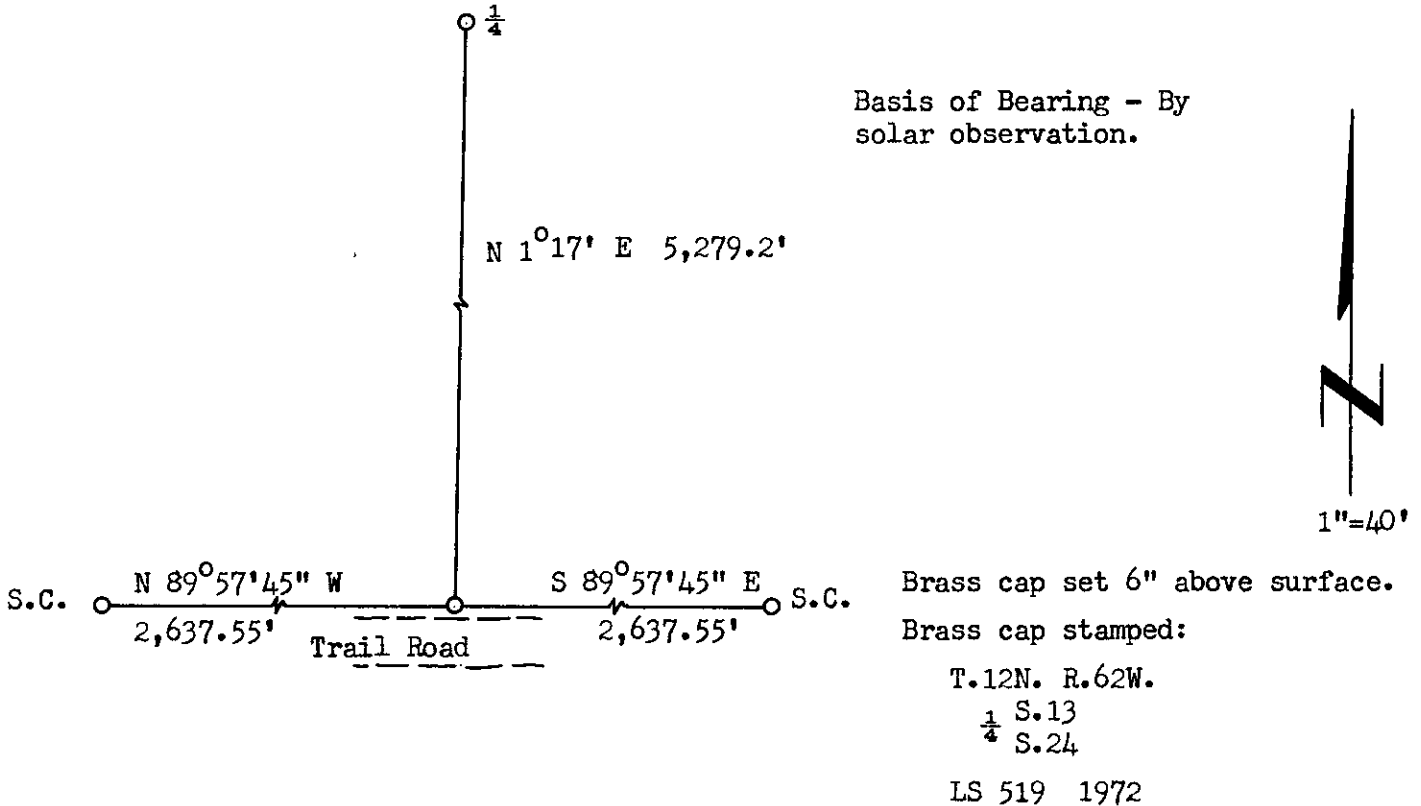

I, R.L. Hudson certify that I have carefully performed or reviewed the work done on the diagrammed corner as reported on this recordation form and approve the same.

R.L. Hudson Wyoming L.S. No. 519
 Signature of Surveyor Registration No.

STATE OF WYOMING,
 Office of Clerk and Recorder,
 County of Laramie

This "corner record" was filed for record on the 30th day of October, 1972, was noted on the cross-index plat and is assigned page No. 12-62, in book No. ONE

John B. Hillman
 County Official

Cross Index No. _____	T. _____	R. _____	Mer. _____
_____	T. _____	R. _____	Mer. _____
_____	T. _____	R. _____	Mer. _____
_____	T. _____	R. _____	Mer. _____
_____	T. _____	R. _____	Mer. _____
_____	T. _____	R. _____	Mer. _____
_____	T. _____	R. _____	Mer. _____

The State of Wyoming
County of Laramie

This instrument was filed for record
at 2:01 o'clock P. M. on the
23rd day of October,
A. D. 1922 and is duly recorded in
Book _____ of _____

[Handwritten Signature]

Deputy Register of Deeds